

# Signaling units

## Ø 84 - 130

Harmony® XVR rotating beacons

Catalog

September **2013**



# How to find the “Automation and Control” products

## > Catalogs

Complete product ranges



## > Essential guides

Selection of the top selling products

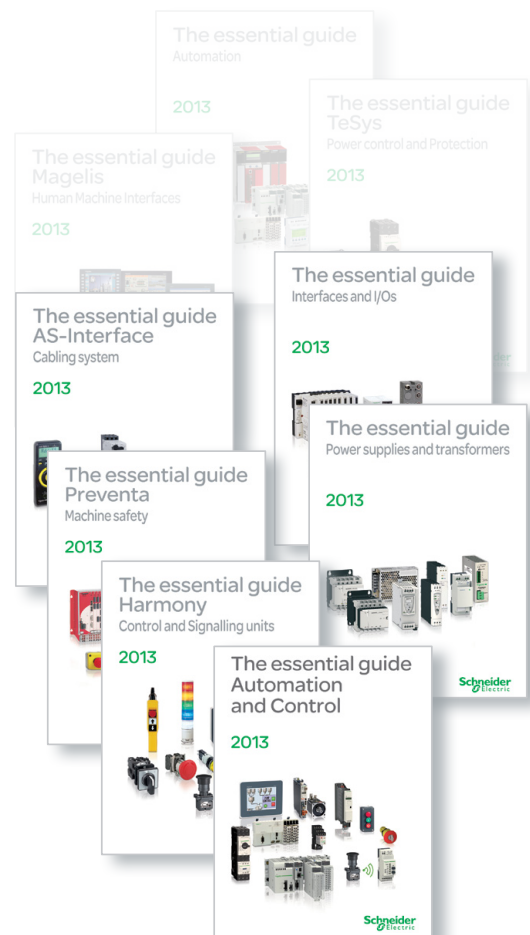

# General contents

## Harmony® XVR rotating beacons

**Selection guide** ..... page 2

### ■ Presentation

□ Rotating beacons, Harmony® type XVR..... page 6

### ■ References

□ Pre-cabled rotating beacons..... page 7

□ Accessories..... page 7

### ■ How to find the “Automation and Control” products

□ Search, visualize, and download ..... page 8

□ Access product references with adapted tools..... page 10

□ Compare, select, and compile ..... page 12

□ Check the product status, design your equipment ..... page 13

■ **Product reference index**..... page 14

Harmony® type XV **Monolithic tower lights**



<b>Type of products</b>	Complete pre-cabled pilot lights, height 55 mm/2.17 in.	Complete miniature beacons	Pre-assembled/pre-cabled tower lights Variable composition tower lights for customer assembly of up to 4 units
<b>Diameter</b>	Ø 25 mm/0.98 in.	Ø 45 mm/1.75 in.	Ø 60 mm/2.36 in.
<b>Degree of protection conforming to IEC 60529</b>	IP 40	IP 40	IP 53 and IP 42 (base mounting) IP 23 (direct aluminium tube mounting, aluminium tube mounting and "L" bracket) IP 53 and IP 42 (aluminium tube mounting and fixing plate) IP 40 (aluminium tube mounting and foldable bracket)
<b>Type of signalling</b>	Steady Flashing "Flash" Sound	Yes – Yes –	Yes – – With buzzer
<b>Light sources</b>	Incandescent bulb LED bulb Integral LED "Flash" discharge tube Halogen bulb	Yes – – Yes –	– – Yes – –
<b>Colors of illuminated units</b>	<input type="checkbox"/> Green <input type="checkbox"/> Red <input type="checkbox"/> Clear <input type="checkbox"/> Yellow	<input type="checkbox"/> Green <input type="checkbox"/> Red <input type="checkbox"/> Orange <input type="checkbox"/> Blue <input type="checkbox"/> Clear <input type="checkbox"/> Yellow	<input type="checkbox"/> Red <input type="checkbox"/> Green <input type="checkbox"/> Amber <input type="checkbox"/> Blue
<b>Connection</b>	Flying leads, length 360 mm/14.17 in.	Screw clamp terminals	Flying leads, length 500 to 560 mm/19.68 to 22.05 in. for tube mounting according to model. Length 900 mm/35.43 in. for base mounting.
<b>Support panel drilling or cut-out</b>	Ø 22 mm/0.87 in. or Ø 30 mm/1.18 in.	3 x Ø 3.3 mm/0.13 in. or M3	Base mounting: 3 x Ø 5 mm/0.20 in. Direct aluminium tube mounting: Ø 20/0.79 in. Aluminium tube mounting and "L" bracket: 2 x Ø 9/0.35 in. Aluminium tube mounting and fixing plate: 4 x Ø 6/0.24 in. Aluminium tube mounting and foldable bracket: 4 x Ø 6/0.24 in.
<b>Type references</b>	XV1CA	XVDLS	XVG



<b>Type of products</b>	Pre-assembled and pre-cabled tower lights	Pre-assembled and pre-cabled tower lights	Pre-assembled and pre-cabled tower lights	Pre-assembled and pre-cabled USB tower lights
<b>Diameter</b>	Ø 40 mm/1.57 in.	Ø 60 mm/2.36 in.	Ø 100 mm/3.94 in.	Ø 60 mm/2.36 in.
<b>Degree of protection conforming to IEC 60529</b>	IP 54 (flat surface installation) IP 23 (vertical surface installation)	IP 54 (flat surface installation) IP 23 (vertical surface installation)	IP 54 (flat surface installation)	IP 42
<b>Type of signalling</b>	Yes Yes – With buzzer – – Yes – –	Yes Yes – With buzzer – – Yes – –	Yes Yes – With siren or buzzer – – Yes – –	Yes Yes – With buzzer (volume control and alarm type can be set with HMI) – – Yes – –
<b>Light sources</b>	– – – – – –	– – – – – –	– – – – – –	– – – – – –
<b>Colors of illuminated units</b>	<input type="checkbox"/> Red <input type="checkbox"/> Orange <input type="checkbox"/> Green <input type="checkbox"/> Blue <input type="checkbox"/> Clear	<input type="checkbox"/> Red <input type="checkbox"/> Orange <input type="checkbox"/> Green <input type="checkbox"/> Blue <input type="checkbox"/> Clear	<input type="checkbox"/> Red <input type="checkbox"/> Orange <input type="checkbox"/> Green <input type="checkbox"/> Blue <input type="checkbox"/> Clear	Multi-color LEDs (many possible combinations can be set with HMI) <input type="checkbox"/> Red <input type="checkbox"/> Orange <input type="checkbox"/> Green <input type="checkbox"/> Blue
<b>Connection</b>	Flying leads, length 450 mm/17.71 in. to 900 mm/35.43 in. according to model	Flying leads, length 450 mm/17.71 in. to 850 mm/33.46 in. according to model	Flying leads, length 500 mm/19.68 in.	USB power cable: - 300 mm/11.81 in. for tube mounting - 400 mm/15.75 in. for direct mounting
<b>Support panel drilling or cut-out</b>	Mounting on support tube with bracket: 2 x Ø 9 mm/0.35 in. Direct mounting on horizontal support: 3 x Ø 5 mm/0.20 in. Other mounting possibilities with accessories	Mounting on support tube with bracket: 2 x Ø 11 mm/0.43 in. Direct mounting on horizontal support: 3 x Ø 5 mm/0.20 in. Other mounting possibilities with accessories	Direct mounting on horizontal support: - 3 x Ø 6 mm/0.24 in. (without siren) - 3 x Ø 7 mm/0.28 in. (with siren) Other mounting possibilities with accessories	Mounting on support tube with fixing plate: 4 x Ø 6 mm/0.24 in. Direct mounting on horizontal support: 3 x Ø 5 mm/0.20 in.
<b>Type references</b>	XVC4	XVC6	XVC1	XVGU

Harmony® type XV

Modular tower lights



<b>Type of products</b>	Pre-assembled/pre-cabled tower lights Variable composition tower lights for customer assembly of up to 5 units	Tower lights for customer assembly of up to 5 units.
<b>Diameter</b>	Ø 45 mm/1.77 in.	Ø 60 mm/2.36 in.
<b>Degree of protection conforming to IEC 60529</b>	IP 54 in vertical position (XVM with plastic fixing plate) IP 42 in horizontal position (XVM with metal bracket) IP 40 in other positions (all types of XVM tower lights)	IP 65 for illuminated units IP 54 for audible units IP 55 for flexible mounting option
<b>Type of signalling</b>	Steady Flashing "Flash" Sound	Yes Yes Yes Yes
<b>Light sources</b>	Incandescent bulb LED bulb Integral LED "Flash" discharge tube Halogen bulb	Yes Yes Yes Yes Yes
<b>Colors of illuminated units</b>	<input type="checkbox"/> Red <input type="checkbox"/> Green <input type="checkbox"/> Orange <input type="checkbox"/> Blue <input type="checkbox"/> Clear	<input type="checkbox"/> Green <input type="checkbox"/> Red <input type="checkbox"/> Orange <input type="checkbox"/> Blue <input type="checkbox"/> White <input type="checkbox"/> Yellow (only for multi-color unit with above colors)
<b>Connection</b>	Flying leads, length 300 mm/11.81 in. or screw terminals	Spring cage connection terminals
<b>Support panel drilling or cut-out</b>	Mounting on bracket: 2 x Ø 9 mm /0.35 in. Mounting on support tube: 4 x Ø 5.5 mm/0.22 in. or M5	Mounting on support tube and adjustable support tube: 4 x Ø 6 mm/0.24 in.  Direct mounting and Flexible wall mounting: 3 x Ø 5 mm/0.196 in.
<b>Type references</b>	XVM	XVU

Rotating beacons      Sound solutions

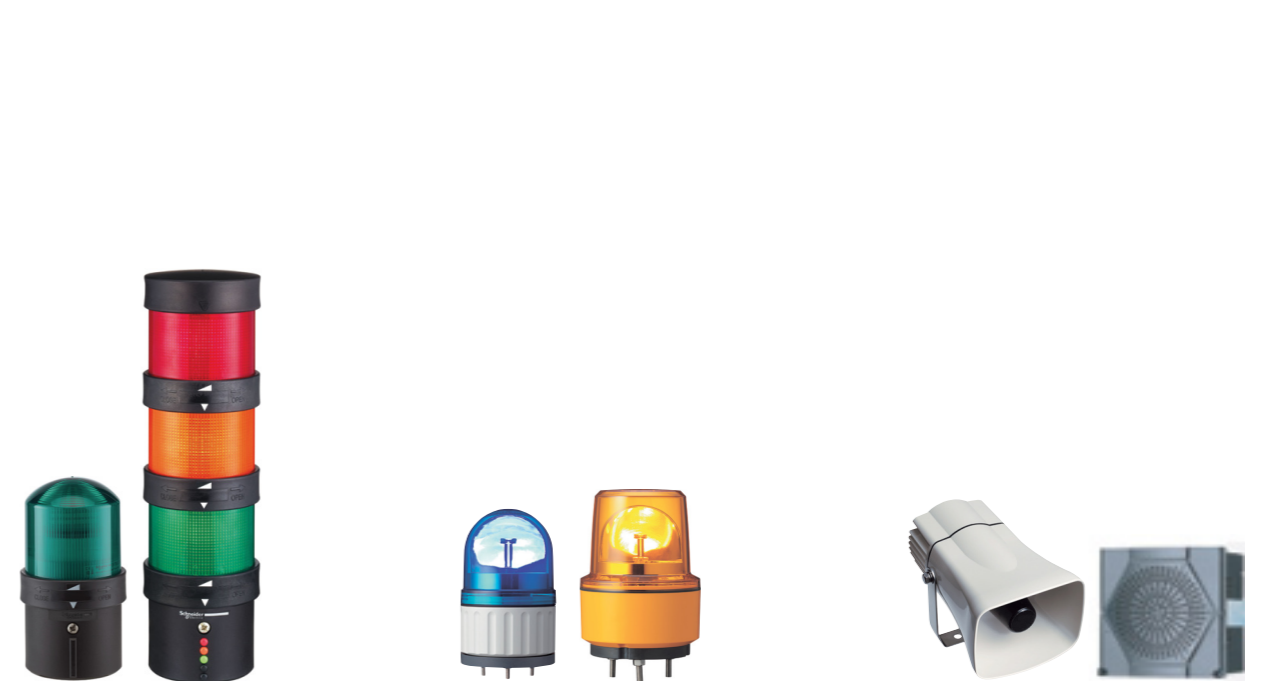

<b>Type of products</b>	Illuminated beacons Variable composition tower lights for customer assembly of up to 5 units	Pre-cabled rotating beacons	Sirens and electronic alarms
<b>Diameter</b>	Ø 70 mm/2.76 in.	Ø 84 mm/3.31 in. to Ø 130 mm/5.12 in.	–
<b>Degree of protection conforming to IEC 60529</b>	IP 65 (mounted on fixing base XVBZ0●) IP 66 (mounted on base unit)	Ø 84 mm/3.31 in. and Ø 106 mm/4.17 in.: IP 23 (IP 65 with accessory) Ø 120 mm/4.72 in.: IP 23 Ø 130 mm/5.12 in.: IP 66 and IP 67 (depending on voltage)	IP 53 (sirens) IP 54 (electronic alarms)
<b>Type of signalling</b>	Yes Yes Yes Yes Yes	Yes – – Yes –	– – – Yes –
<b>Light sources</b>	Yes "PROTECTED LED" "PROTECTED LED" Yes –	– "Super Bright" – – Yes	– – – – –
<b>Colors of illuminated units</b>	<input type="checkbox"/> Green <input type="checkbox"/> Red <input type="checkbox"/> Orange <input type="checkbox"/> Blue <input type="checkbox"/> Clear <input type="checkbox"/> Yellow	<input type="checkbox"/> Red <input type="checkbox"/> Orange <input type="checkbox"/> Green <input type="checkbox"/> Blue	–
<b>Connection</b>	Screw clamp terminals	Flying leads, length 400 mm/15.75 in.(except XVR08: 500 mm/19.68 in.)	Screw clamp terminals (except XVS14: flying leads, length 500 mm/19.68 in.)
<b>Support panel drilling or cut-out</b>	Mounting on support tube: 4 x Ø 5.5 mm/0.22 in. or M5 Vertical mounting: 3 x Ø 5 mm/0.20 in. or M5 Direct mounting: 2 x Ø 4.5 mm/0.18 in. or M4	Depending on model: - XVR08 (Ø 84 mm/3.31 in.): 3 x Ø 5 mm/0.20 in. - XVR10 (Ø 106 mm/5.12 in.): 3 x Ø 5 mm/0.20 in. - XVR12 (Ø 120 mm/4.72 in.): 3 x Ø 6 mm/0.24 in. - XVR13 (Ø 130 mm/5.12 in.): 3 x Ø 9 mm/0.35 in. - XVR13●●L (Ø 130 mm/5.12 in.): 3 x Ø 7 mm/0.28 in.	3 x Ø 6.5 mm/0.25 in.
<b>Type references</b>	XVBL, XVBC	XVR	XVS

# Signaling Units

## Rotating beacons

### Harmony® type XVR (equipped with Super Bright LED)



#### Presentation

The rotating beacons in the Harmony® XVR range are optical signaling units designed for long distance signaling applications. They are used mainly in the iron and steel industry, on industrial handling vehicles or for safety applications.

The range involves complete products offering simplicity of use and speed of installation: they are supplied pre-cabled, and equipped with their light source. The use of "Super-bright" LED guarantees a good illuminating power and a long service life (reduced time for maintenance) owing to their high resistance to mechanical shock and vibration. These light sources are also energy saving with low power consumption. A reflecting prism can be used for increasing light diffusion.

4 sizes are available:

- Ø 84 mm (XVR08). Colors : Red, Orange, Green and Blue,
- Ø 106 mm (XVR10). Colors : Red, Orange, Green and Blue,
- Ø 120 mm (XVR12). Colors : Red, Orange, Green and Blue,
- Ø 130 mm (XVR13). Colors : Red, Orange.

For more efficiency, Ø 120 mm rotating beacons may be delivered with a complementary audible unit: a buzzer present at the base of the product, with a continuous or intermittent tone and an adjustable sound level of 50 dB to 90 dB at 1 m.

#### Environment

XVR rotating beacons can offer a high degree of protection:

- owing to the adjunction of an accessory : a rubber base guarantees a degree of protection type IP 55 or IP 65 for small models,
- according to the selected model: Ø 130 mm rotating beacons guarantee a degree of protection type IP 66 (resistant to vibration) or IP 67 (see opposite page).

These products meet the requirements of the following standards:

- EN/IEC 61000-6-2 and EN/IEC 61000-6-4 for Ø 84 mm (XVR08), 106 mm (XVR10), 120 mm (XVR12) and 130 mm with direct current (XVR13B●● and XVR13J●●),
- EN/IEC 60947-1 and EN/IEC 60947-5-1 for the other Ø 130 mm rotating beacons (XVR13●●L) with voltage 24V A.C./D.C., 120 V A.C. or 230 V A.C.

These products are CE, UL and CSA certified.

#### Connection

The connection is through flying leads, length 400 mm (500 mm for XVR08) and section 0.83 mm<sup>2</sup> (1,25 mm<sup>2</sup> for XVR13).

# Signaling Units

## Rotating beacons

### Harmony® type XVR (equipped with Super Bright LED)



#### Complete, pre-cabled rotating beacons

Diameter mm	Sound option	IP degree of protection	Voltage V	Color	Reference	Weight kg	
Ø 84	Without buzzer	IP 23 (IP 65 With accessories)	~ 12	Red	XVR08J04	0.300	
				Orange	XVR08J05	0.300	
				Green	XVR08J03	0.300	
			~ 24	Blue	XVR08J06	0.300	
				Red	XVR08B04	0.300	
				Orange	XVR08B05	0.300	
	Ø 106	Without buzzer	IP 23 (IP 55 With accessories)	~ 12	Red	XVR10J04	0.500
					Orange	XVR10J05	0.500
					Green	XVR10J03	0.500
				~ 24	Blue	XVR10J06	0.500
					Red	XVR10B04	0.500
					Orange	XVR10B05	0.500
Ø 120		Without buzzer	IP 23	~ 12	Red	XVR12J04	0.500
					Orange	XVR12J05	0.500
					Green	XVR12J03	0.500
				~ 24	Blue	XVR12J06	0.500
					Red	XVR12B04	0.500
					Orange	XVR12B05	0.500
	Ø 120	With buzzer Continuous or intermittent tone Sound level at 1 m: 50 to 90 dB	IP 23	~ 12	Red	XVR12J04S	0.500
					Orange	XVR12J05S	0.500
					Green	XVR12J03S	0.500
				~ 24	Blue	XVR12J06S	0.500
					Red	XVR12B04S	0.500
					Orange	XVR12B05S	0.500
Ø 130		Without buzzer	IP 66 Resistant to vibration	~ 12	Red	XVR13J04	0.800
					Orange	XVR13J05	0.800
				~ 24	Red	XVR13B04	0.800
			Orange		XVR13B05	0.800	
			IP 66 and IP 67	~ 24	Red	XVR13B04L	0.820
					Orange	XVR13B05L	0.820
	~ 120	Red		XVR13G04L	0.990		
		Orange		XVR13G05L	0.990		
	~ 230	Red		XVR13M04L	0.990		
		Orange		XVR13M05L	0.990		

#### Accessories for rotating beacons

Description	To be used for / with	Diameter mm	Height mm	Reference	Weight kg
Reflecting prism	Increasing light diffusion	84	–	XVRZR1	0.010
		106	–	XVRZR2	0.015
		120/130	–	XVRZR3	0.020
Rubber base	Reaching IP 65	84	–	XVRZ081	0.040
	Reaching IP 55	106	–	XVRZ082	0.050
Metal angle bracket	Horizontal support	84, 106, 120	–	XVCZ23	0.380
		130	–	XVR012L	1.300
Metal fixing plate	Horizontal support	106, 120	300	XVCZ13	0.700

# Search, visualize, and download

Use your tablet or your PC to quickly access detailed and comprehensive information on our products



## Tablets

Application name: "Automation Library by Schneider Electric"

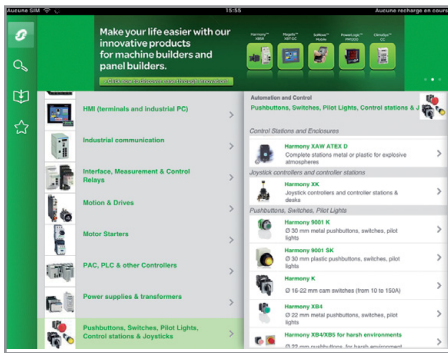

Product ranges displayed by function

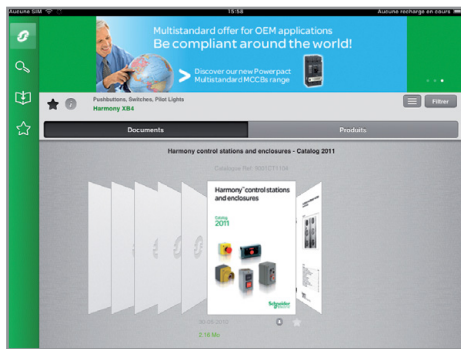
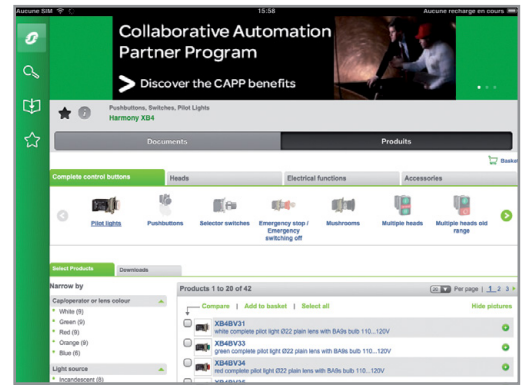

Dynamic catalogs (hyperlinks, video, ...)

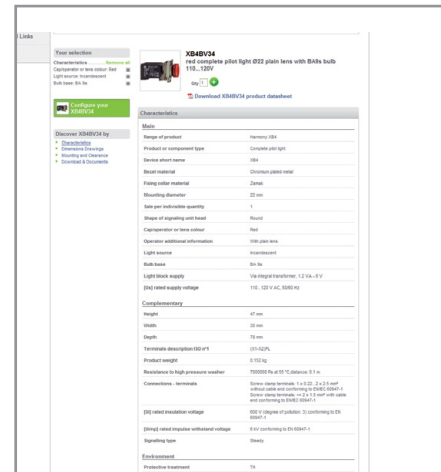

Product selector: dynamic filters to get easily your part number



# Personal computer

Path: [www.schneider-electric.com](http://www.schneider-electric.com) > **Products and Services** > Automation and control > Product offer

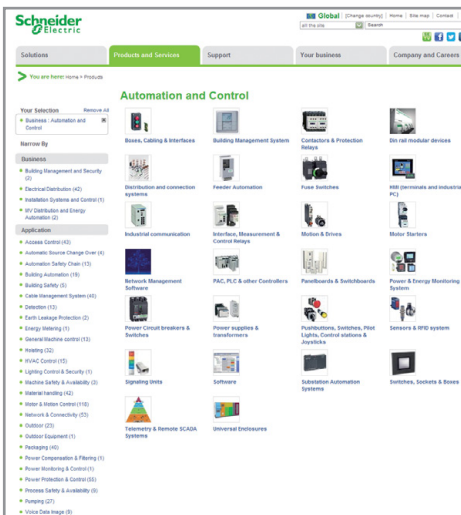

Product ranges displayed by function

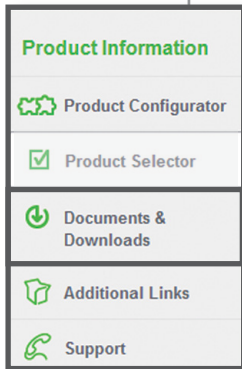
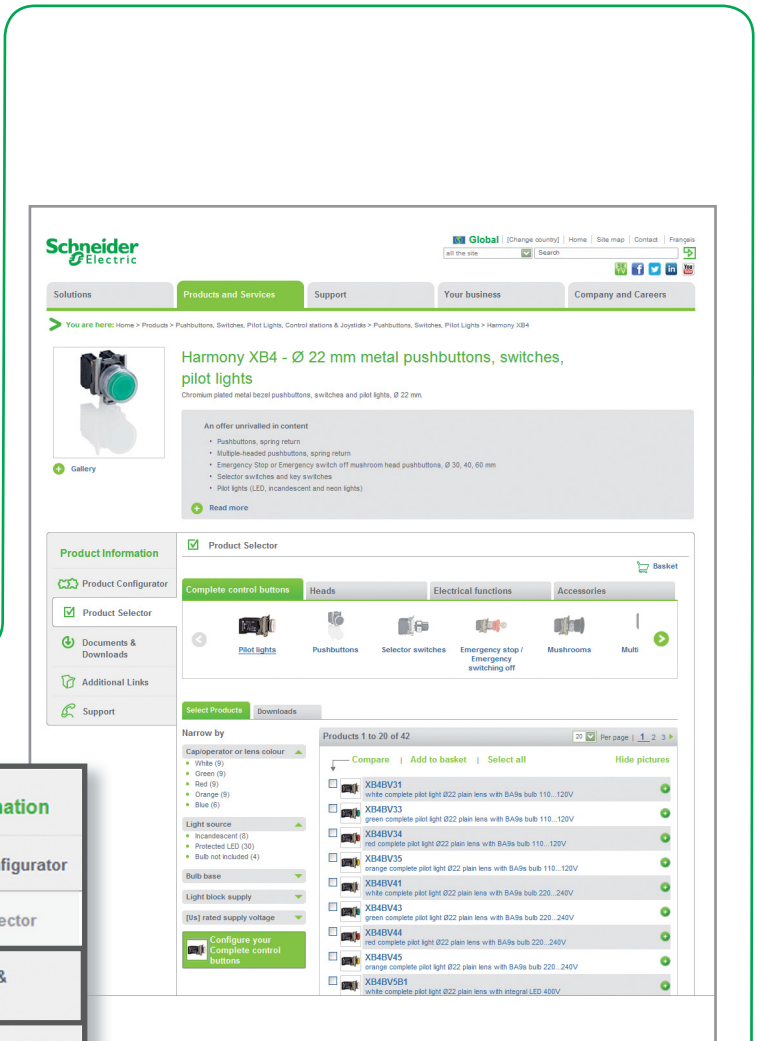

Dynamic catalogs (hyperlinks, video, ...)

Product selector: dynamic filters to get easily your part number

# Access product references with adapted tools



Path: [www.schneider-electric.com](http://www.schneider-electric.com) > **Products and Services** > Automation and control > ... > Product offer

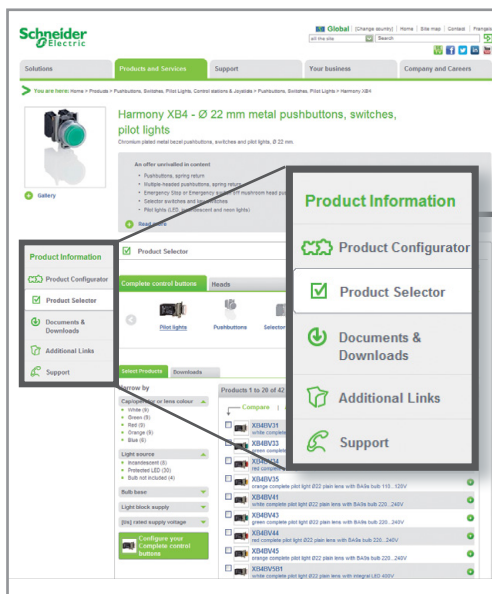

**Graphic product configurator**  
Select the right product with just a few clicks

**Dynamic product selector**  
Visualize product characteristics and dimensions

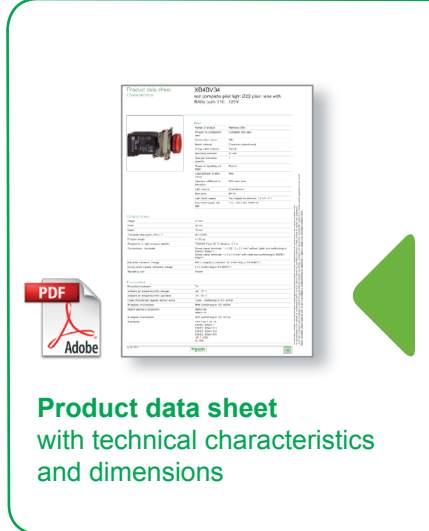
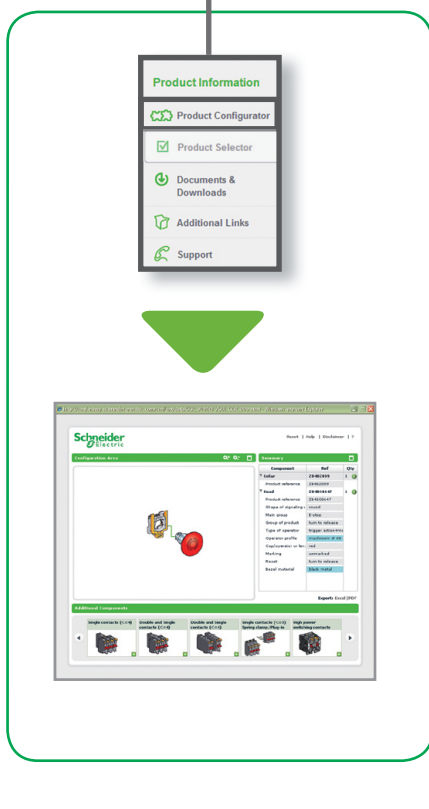

**Product data sheet**  
with technical characteristics  
and dimensions

**Dimensions**

**Technical characteristics**



# Compare, select, and compile



Path: [www.schneider-electric.com](http://www.schneider-electric.com) > **Products and Services** > Automation and control > ... > Harmony XB4\*

**Compare**  
technical  
characteristics

**Select**  
and store  
your products  
into  
the basket

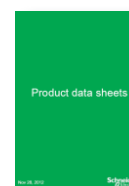

**Compile**  
data sheets  
in a unique  
document

\* Example of research on a product

# Check the product status, design your equipment



Path: [www.schneider-electric.com](http://www.schneider-electric.com) > **Support** > Product Substitution Tool  
 Path: [www.schneider-electric.com](http://www.schneider-electric.com) > **Support** > CAD files

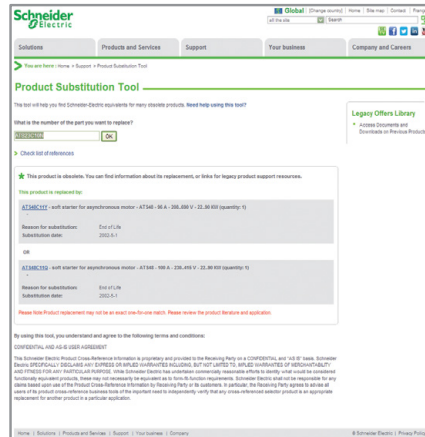
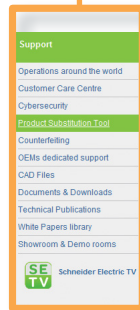

**Product status:**  
 indicate whether the product is still commercialized. Otherwise, the tool suggests a product substitution.

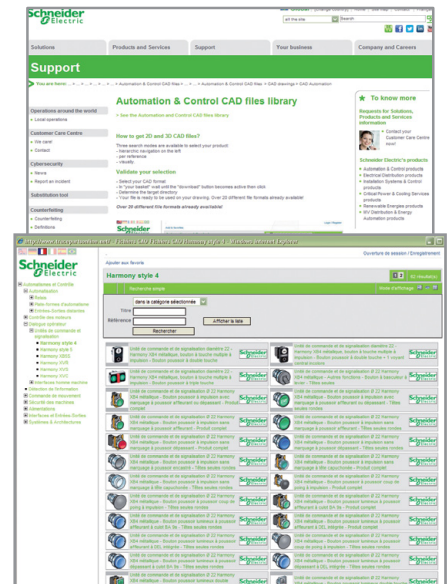

**CAD files:**  
 available in various formats they will be easily integrated into your installation design software.

Please note that references to products and services are just examples.

---

X	
XVCZ13	7
XVCZ23	7
XVR08B03	7
XVR08B04	7
XVR08B05	7
XVR08B06	7
XVR08J03	7
XVR08J04	7
XVR08J05	7
XVR08J06	7
XVR10B03	7
XVR10B04	7
XVR10B05	7
XVR10B06	7
XVR10J03	7
XVR10J04	7
XVR10J05	7
XVR10J06	7
XVR12B03	7
XVR12B03S	7
XVR12B04	7
XVR12B04S	7
XVR12B05	7
XVR12B05S	7
XVR12B06	7
XVR12B06S	7
XVR12J03	7
XVR12J03S	7
XVR12J04	7
XVR12J04S	7
XVR12J05	7
XVR12J05S	7
XVR12J06	7
XVR12J06S	7
XVR012L	7
XVR13B04	7
XVR13B04L	7
XVR13B05	7
XVR13B05L	7
XVR13G04L	7
XVR13G05L	7
XVR13J04	7
XVR13J05	7
XVR13M04L	7
XVR13M05L	7
XVRZ081	7
XVRZ082	7
XVRZR1	7
XVRZR2	7
XVRZR3	7



**Schneider Electric Industries SAS**

Head Office  
35, rue Joseph Monier  
F-92500 Rueil-Malmaison  
France

[www.schneider-electric.com](http://www.schneider-electric.com)

The information provided in this documentation contains general descriptions and/or technical characteristics of the performance of the products contained herein. This documentation is not intended as a substitute for and is not to be used for determining suitability or reliability of these products for specific user applications. It is the duty of any such user or integrator to perform the appropriate and complete risk analysis, evaluation and testing of the products with respect to the relevant specific application or use thereof. Neither Schneider Electric nor any of its affiliates or subsidiaries shall be responsible or liable for misuse of the information contained herein.

Design: Schneider Electric  
Photos: Schneider Electric  
Printed by:

DIA5ED2130803EN

September 2013